

# Product Information

## FIMINSENIN - Minibeast Sensory Insert

BS EN 1176 - Designed to British & European Standards



### MATERIALS

Panel - Two Colour High Density Polyethylene (HDPE)

### SUPPLY METHOD

Insert - Fully assembled

### FEATURES

-  **ROLLERBALL** - Frog eyes
-  **SLIDERS** - Injection moulded counter
-  **ROTATE** - Micro flower rotor



Insert can be easily attached to your own panel

### DIMENSIONS

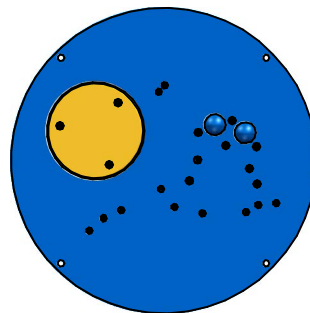
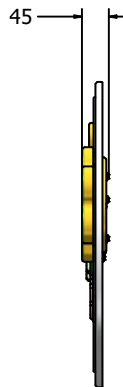
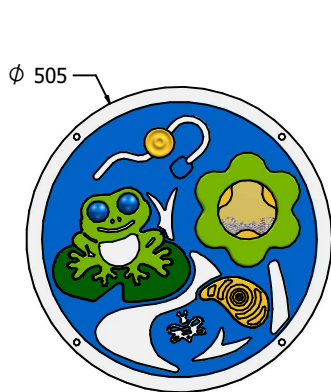

### Host Panel Fixing Detail

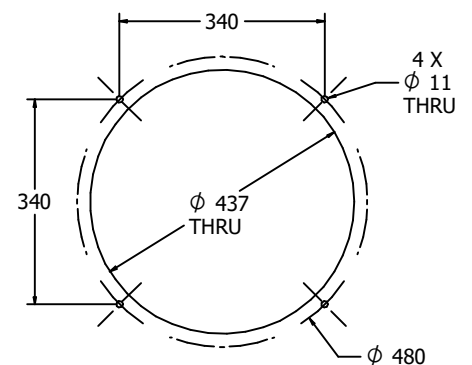

### TECHNICAL

Age Range: 2+ Years  
 Largest Part: FIMINSENIN -  $\phi 505 \times 45$ mm  
 Total Weight: FIMINSENIN - 4kg  
 Surfacing: N/A

IMPORTANT: you must specify the colour option you require at the time of order if it is different from the colour listed/shown above, requirements are subject to availability at the time of order