

# Product Information

## FIMPDBS-15 - Multi-Play Dual Bar Slide

**BS EN 1176** - Designed to British & European Standards

### MATERIALS

**Panel** - Two Colour  High Density Polyethylene (HDPE)

**Barslide** - Stainless Steel

### SUPPLY METHOD

**Entry Panel & Dual Bar Slide** - Supplied seperately with the fixings needed to attach to platform and each other  
(Fixings to attach to posts not included.)

### FEATURES



**SLIDE** - Dual Bar Slide



FIMPDBS900-15  
(For 0.9m Platform)



FIMPDBS1500-15  
(For 1.5m Platform)



FIMPDBS1200-15  
(For 1.2m Platform)

### DIMENSIONS

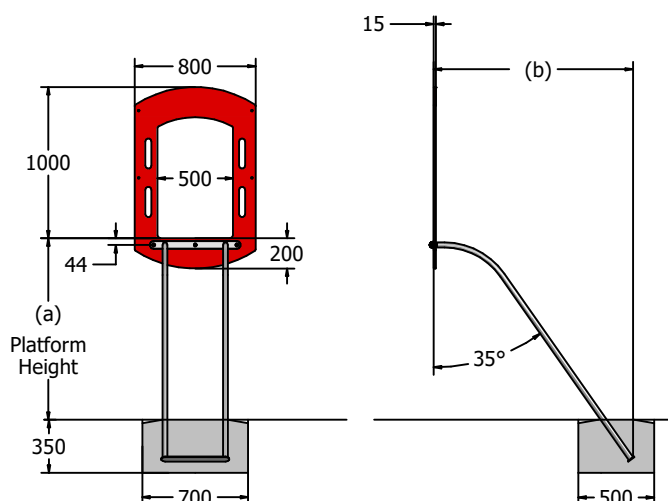

(a)	(b)
900mm	1110mm
1200mm	1320mm
1500mm	1430mm

### TECHNICAL

**Age Range:** 4+ Years  
**Largest Part:** Bar Slide (a)+280 x (b)  
**Heaviest Part:** Bar Slide Approx. (0.9m = 10kg), (1.2m = 11.5kg), (1.5m = 20kg)  
**Total Weight:** Approx. (0.9m = 16.5kg), (1.2m = 18.5kg), (1.5m = 27kg)  
**Free Space:** Cylinder with a 2m diameter x 1.5m height measured from the centre line between the slide bars  
**Surfacing:** 1.5m from the extents of the equipment with a critical fall height in excess of (a)

IMPORTANT: you must specify the colour option you require at the time of order if it is different from the colour listed/shown above, requirements are subject to availability at the time of order